



# Beachside

HOLIDAY PARK  
IN BEAUTIFUL ST. IVES BAY

01736 753080  
[www.beachside.co.uk](http://www.beachside.co.uk)







**Chalets**  
**Bungalows**  
**Apartments**  
**Lodges**  
**Touring pitches**  
**Camping pitches**  
**Right on the beach**



Beachside is  
a no dog park.

**01736 753080**  
**www.beachside.co.uk**

## WELCOME

Beachside Holiday Park lies on the edge of the fabulous St Ives Bay, set amid sand dunes on one of the country's finest golden sandy beaches.

At Beachside there is a restful, carefree and less commercial atmosphere that is perfect to help you unwind during your holiday in Cornwall.

With its own beach access, Beachside is the perfect choice for a seaside holiday and its location makes it an ideal base for exploring the towns, sights and attractions that west Cornwall has to offer. Nearby, there is also an excellent choice of restaurants and pubs with good food to suit all tastes.

Beachside, family-run for more than 55 years, focuses on providing holidays solely for families and couples. With a friendly and personal service, not to mention a great location, it is easy to see why we welcome many families back to Beachside year after year.



We have a range of accommodation suitable for all budgets and offer pitches with and without electric hook-up. All our on-site facilities are available free of charge.

We look forward to welcoming you to Beachside.

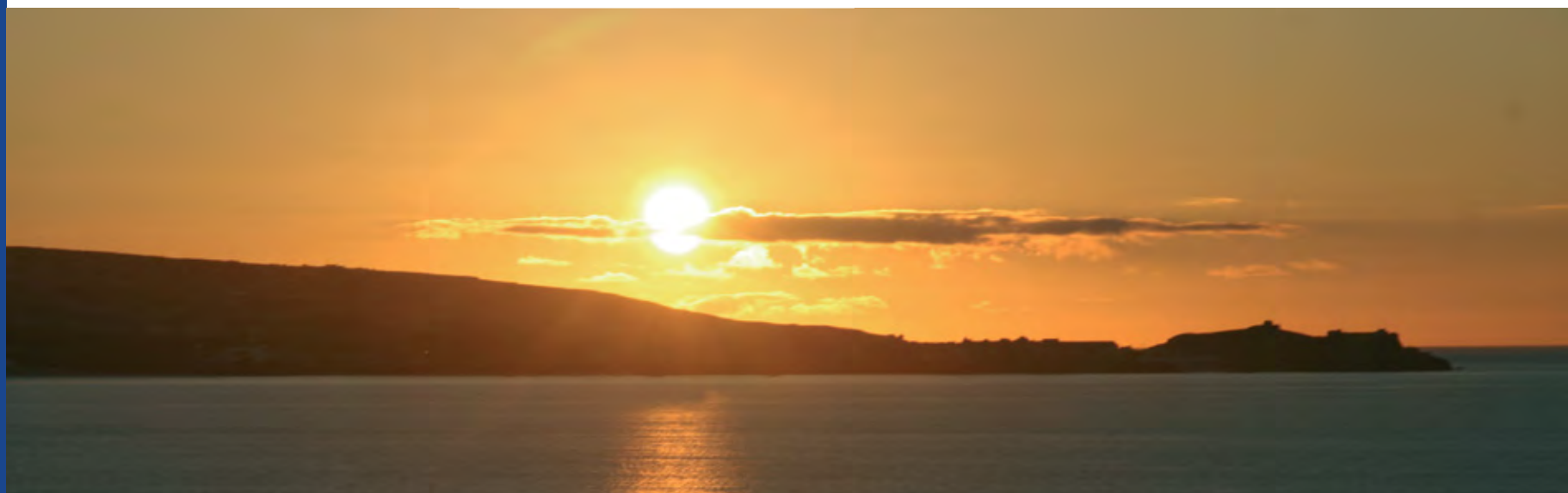



**Heated outdoor pool**

**Free WiFi**

**Children's playgrounds**

**Bar**

**Entertainment**

**Shop**

**Launderette**

**Games room**

**Table tennis**

**Large recreation area**

**Surfing**



**Book online today!**

To see our prices, book and see our latest special offers and short breaks, please visit

**[www.beachside.co.uk](http://www.beachside.co.uk)**



We are continually updating our Facebook page with news and pictures of what's going on at Beachside. Feel free to join us online.

**[www.facebook.com/beachsideholidaypark](https://www.facebook.com/beachsideholidaypark)**



Please see the enclosed letter to check the opening times of the shop, bar and swimming pool during early and late season

**01736 753080**  
**[www.beachside.co.uk](http://www.beachside.co.uk)**





## FACILITIES

### Swimming Pool

Beachside has an outdoor heated swimming pool and a paddling pool, ideal for toddlers. There is also a sun terrace perfect for sunbathing after your swim. The pool is open daily from the beginning of May until the end of September and is available free of charge, exclusively, for guests staying at Beachside.







## Bar, Shop and Other Facilities

At Beachside we have a family bar which is open every evening for a pleasant drink, where you can admire the view or enjoy the stunning sunsets. There is family entertainment several evenings a week during peak season. We also offer a popular children's magic show, sports and craft activities during school holidays.

Our reasonably-priced shop is open daily and is well stocked with fresh groceries, newspapers, beach goods and offers takeaway hot and cold food. Also on site there is a launderette, children's playgrounds, table tennis and a games room with pool tables, video games and other amusements. We have a surf school located on the park that offers surf lessons to small groups on the beach in front of Beachside, along with other activities such as kayaking, coasteering and stand-up paddle boarding nearby.

Please check the enclosed letter for dates of entertainment and opening during early and late season.



**Beachside**  
HOLIDAY PARK



Free high-speed Wi-Fi is available around the main complex and within all accommodation.

Beachside is a dog-free site

**01736 753080**  
**[www.beachside.co.uk](http://www.beachside.co.uk)**





## TOURING & CAMPING

Our pitches are available from Saturday to Saturday in peak season and often become fully booked well in advance so booking ahead is recommended. We welcome people for short breaks on our pitches at all other times of year.



## Touring Pitches

Our spacious touring pitches include electric hook-up and are suitable for caravans, tents and motorhomes. There is space for you to park your car on your pitch and nearby there are water and waste disposal points. The use of all our amenities is free of charge. This includes hot showers, washbasins, WCs, dishwashing sinks and a chemical toilet disposal point. You also have free use of the swimming pool and other park facilities.







## Camping Pitches

Our camping pitches do not include electric hook-up and are suitable for tents, caravans and motorhomes. As with our touring pitches, the use of all our amenities is free of charge, however our camping pitches are slightly farther from the amenities.



### Book online today!

To see our prices, book and see our latest special offers and short breaks, please visit

**[www.beachside.co.uk](http://www.beachside.co.uk)**

**01736 753080**  
**[www.beachside.co.uk](http://www.beachside.co.uk)**





## Bay View Lodge

- Lounge with corner suite, dining table and chairs, television, DVD Player and electric heater
- Decking area with panoramic view across St Ives Bay, with BBQ, sunloungers and table and chairs
- Kitchen with sink, storage cupboards, fridge, microwave, toaster, electric cooker and dishwasher
- Bedroom with double bed, wardrobe, dresser and electric heater
- Bedroom with double bed, bunk beds, wardrobe and electric heater
- Bathroom with wash basin, WC and shower over the bath

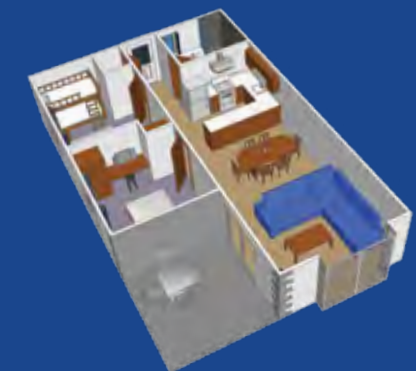

## Seafront Lodge

- Lounge with corner suite, dining table and chairs, television, DVD Player and electric heater
- Decking area with table and chairs
- Kitchen with sink, storage cupboards, fridge, microwave, toaster, electric cooker and dishwasher
- Bedroom with double bed, wardrobe, dresser and electric heater
- Bedroom with double bed, bunk beds, wardrobe and electric heater
- Bathroom with wash basin, WC and shower over the bath

## ACCOMMODATION

All accommodation is based on a standard provision of two bedrooms: one with a double bed and one with a double bed plus bunk beds.

This is ideal for two couples or a family with children. Please note that our accommodation is not suitable for six adults and we do not allow pets at Beachside.

Duvets, pillows and bed linen are provided free of charge. Please bring your own towels and tea towels. Cutlery, crockery and cooking utensils are provided.

Electricity is either by prepayment meter or included, depending on accommodation type. Accommodation has parking for one car outside for your added convenience. Please note that all our accommodation is non-smoking.



### Book online today!

To see our prices, book and see our latest special offers and short breaks, please visit

[www.beachside.co.uk](http://www.beachside.co.uk)



SEAFRONT LODGE



BAY VIEW LODGE

## Bay View Lodge

Our unique, one-off bay view lodge offers a beautiful, unique location right at the front of the park. The bay view lodge has its own extended decking with panoramic views from St Ives Bay right around to Godrevy lighthouse and stands just metres away from the golden sandy beach at the front of Beachside.

## Seafront Lodges

Our newly-built, luxury seafront lodges offer an unrivalled location, each one with a panoramic view across St Ives Bay and just metres away from the golden sandy beach at the front of Beachside. Each semi-detached seafront lodge has a private veranda, is fully double glazed for extra warmth and finished to a very high standard.



BAY VIEW & SEAFRONT LODGES





DUNE LODGE



### Dune Lodge

- Lounge with suites, dining table and chairs, television, DVD Player and electric heater
- Patio area with table and chairs
- Kitchen with sink, storage cupboards, fridge, microwave and electric cooker
- Bedroom with double bed, wardrobe, dresser and electric heater
- Bedroom with double bed, bunk beds, wardrobe and electric heater
- Bathroom with wash basin, WC and shower over the bath



DUNE LODGE

## Dune Lodges

Our comfortable holiday lodges are equipped to a high standard and have a sliding patio door onto a private veranda with patio table and chairs. Each dune lodge is fully double-glazed and are well insulated making them ideal for early and late season.



DUNE LODGE



Free high-speed Wi-Fi is available around the main complex and within all accommodation.

**01736 753080**  
[www.beachside.co.uk](http://www.beachside.co.uk)





## Apartment

- Lounge with corner suite, dining table and chairs, television, DVD Player and electric heater
- Covered patio with table and chairs
- Kitchen with sink, storage cupboards, fridge, microwave, toaster, electric cooker and dish washer
- Bedroom with double bed, wardrobe, dresser and electric heater
- Bedroom with double bed, bunk beds, wardrobe and electric heater
- Bathroom with wash basin, WC and walk-in shower
- Large airing cupboard with washing machine



## Bungalow

- Lounge with suites, dining table and chairs, television, DVD Player and electric heater
- Patio area with table and chairs
- Kitchen with sink, storage cupboards, fridge, microwave, toaster and electric cooker
- Bedroom with double bed, wardrobe, dresser and electric heater
- Bedroom with double bed, bunk beds, wardrobe and electric heater
- Bathroom with wash basin, WC and shower over the bath



## Apartments

Each of our holiday apartments is designed around a central covered patio, providing extra space for you and your family. They are in blocks of four and fully equipped to a very high standard with extras such as a dishwasher and washing machine, allowing you to relax on your holiday.



## Bungalows

Our holiday bungalows offer extra comfort for your holiday. They are detached, brick-built and situated amid the sand dunes and each one has a sea view. The bungalows have a sliding patio door opening onto your own veranda with patio table and chairs.







CHALET Plus

## Chalet Plus

Our holiday chalets plus are of a unique design and are built in blocks of four. They have a central covered patio area, which provides a pleasant indoor/outdoor area perfect for relaxing in and storing all your beach belongings. The spacious design of the chalets allows you to enjoy evenings in the living area without disturbing the children after bedtime.



CHALET Plus



CHALET Plus

## Chalets

Our chalets are of the same design as our chalets plus, offering budget accommodation in a superb location. Our chalets do not include a toaster, microwave or decking in the patio.



CHALET



## Chalets & Chalet Plus

- Lounge with corner suite, dining table and chairs, television, and electric heater
- Covered patio with table and chairs
- Kitchen with sink, storage cupboards, fridge, and electric cooker
- Bedroom with double bed, wardrobe, dresser and electric heater
- Bedroom with double bed, bunk beds, wardrobe and electric heater
- Bathroom with wash basin, WC and shower over the bath

**01736 753080**  
[www.beachside.co.uk](http://www.beachside.co.uk)



## Things to see and do nearby:

- Eden Project
- Land's End
- Day trips to Isles of Scilly
- Attractions & theme parks
- Gardens, galleries & museums
- Beautiful Cornish coves & beaches
- Dramatic coastal walks
- Quaint Cornish towns & villages
- Bike hire and cycle paths
- Watersports and activities
- Sea and lake fishing
- Pony trekking
- Golf courses



**Beachside Holiday Park,  
Hayle, Cornwall, TR27 5AW**

**Tel: 01736 753080**

**Fax: 01736 757252**

**Email: [reception@beachside.co.uk](mailto:reception@beachside.co.uk)**

**[www.beachside.co.uk](http://www.beachside.co.uk)**

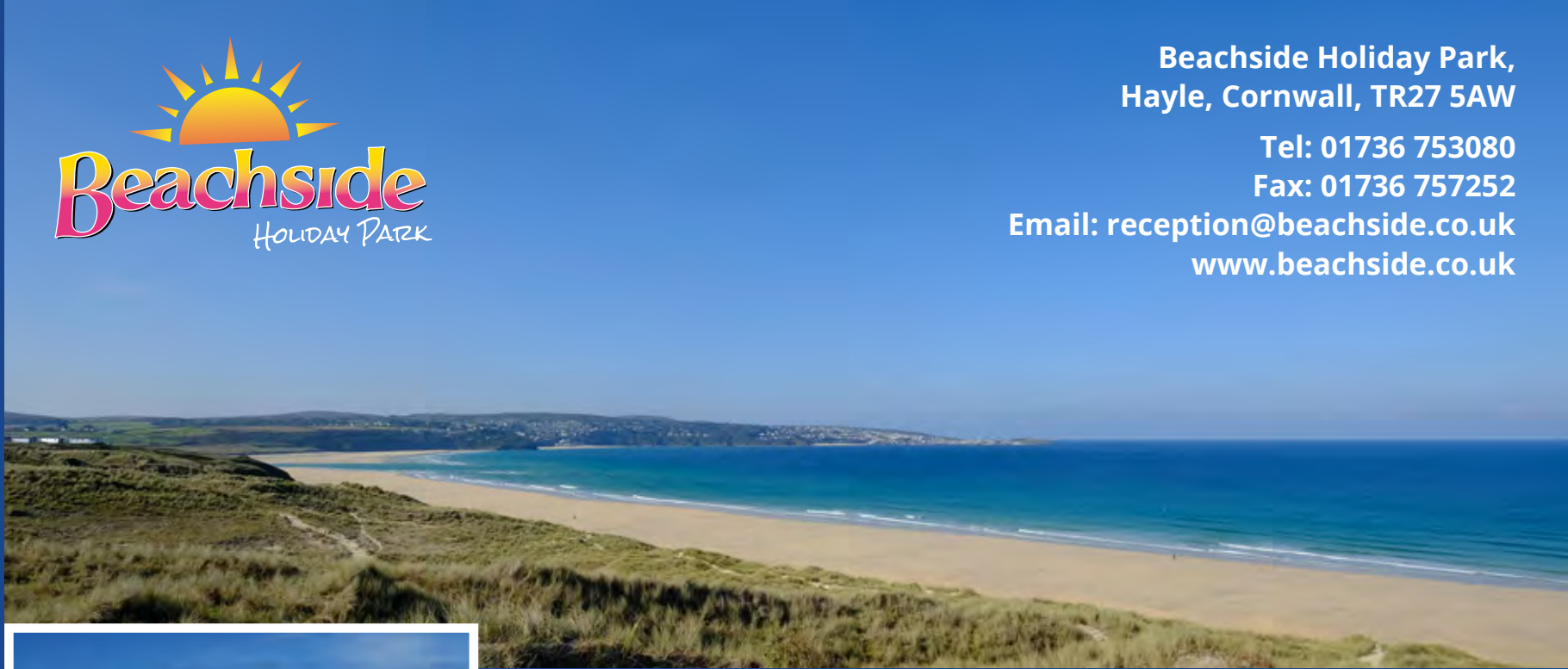

**Eden Project**

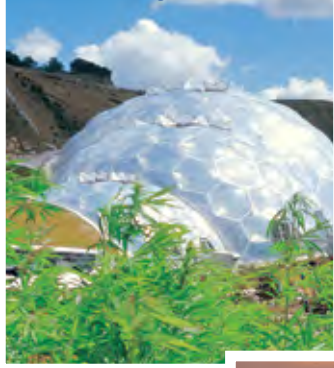

**St. Ives**



**Flambards**



Beautiful beaches, sheltered coves, golden sands, standing stones, coastal walks and great seafood, all set against a historical and magical landscape. There is much to love about Cornwall.

**Lands End**



## DIRECTIONS

Leave the A30 at the large roundabout on the approach to Hayle (Loggans Moor roundabout). Take the exit into Hayle and go straight across the double mini roundabouts.

Turn right opposite the petrol station, following the brown tourist sign to Beachside Holiday Park.

Our entrance is approximately quarter of a mile on the right.

